

VERSTELLBARE FÜHRUNGSBUCHSEN MIT HARTMETALLEINSATZ

ADJUSTABLE GUIDE BUSHINGS WITH CARBIDE INSERT

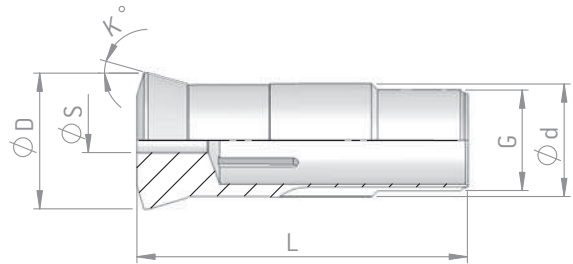

Artikel part no.	ø d (mm)	ø D (mm)	Länge L (mm) length L (mm)	Konus α (Grad) cone α (degree)	Gewinde G thread G	Innenform inside shape	Spannbereich (mm) clamping range (mm)	Steigung (mm) increments (mm)
F 351	9	13	50	30	M 8 x 0,6	○	0,8 - 5,5	0,1
I 351	9	12,5	44	16	M 8 x 0,75	○	0,8 - 5,6	0,1
F 352	11	15	50	30	M 10 x 0,6	○	1,0 - 7,5	0,1
I 352	11	14,5	53	16	M 10 x 0,8	○	1,0 - 7,0	0,1
F 3001	11	14,5	53	16	M 10 x 0,75	○	1,0 - 7,0	0,1
F 103	12	16	50	30	M 12 x 1	○	1,0 - 7,5	0,1
T 340	13	16	41,5	15	M 12,5 x 0,75	○	1,0 - 8,0	0,1
T 330	14	18	63	16	M 13 x 0,75	○	1,0 - 9,0	0,1
I 353	16	19,5	59	16	M 14 x 1	○	1,0 - 10,5	0,1
						⬡	3,0 - 10,0	1,0
						□	3,0 - 6,0	1,0
F 850	16	20	52	30	M 16 x 1	○	1,0 - 12,0	0,1
F 853	18	22	60	30	M 16 x 1	○	1,0 - 13,0	0,1
						⬡	4,0 - 13,0	1,0
						□	3,0 - 8,0	1,0
F 104	20	24	55	30	M 20 x 1	○	2,0 - 13,0	0,1
T 221	21	24	57,5	12	M 18 x 1	○	3,0 - 15,0	0,5
						⬡	4,0 - 12,0	1,0
						□	3,0 - 8,0	1,0
I 354	22	29	68	16	M 19 x 1	○	2,0 - 15,0	0,5
						⬡	4,0 - 13,0	1,0
						□	3,0 - 10,0	1,0
F 391	22	29	68	16	M 22 x 1	○	3,0 - 18,0	0,5
						⬡	4,0 - 14,0	1,0
						□	3,0 - 12,0	1,0
F 605	24	29,5	61	30	M 24 x 1	○	2,0 - 17,0	0,5
						⬡	4,0 - 15,0	1,0
						□	3,0 - 12,0	1,0
TD 26	26	29	77	16	M 25 x 1	○	2,0 - 20,0	0,5
						⬡	4,0 - 16,0	1,0
						□	3,0 - 13,0	1,0

>> Tabelle wird fortgesetzt >> Table to be continued

Führungsbuchsen in Sonderausführungen lieferbar.
Custom solutions can be delivered for all guide bushings.

Alle Führungsbuchsen mit verlängerter Führungsfläche und in Übergröße lieferbar.
All guide bushings available with enlarged guide area and oversize.

VERSTELLBARE FÜHRUNGSBUCHSEN MIT HARTMETALLEINSATZ ADJUSTABLE GUIDE BUSHINGS WITH CARBIDE INSERT

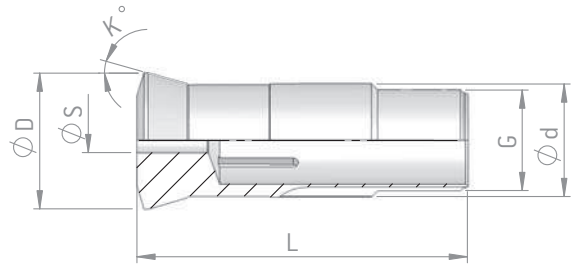

Artikel part no.	$\varnothing d$ (mm)	$\varnothing D$ (mm)	Länge L (mm) length L (mm)	Konus α (Grad) cone α (degree)	Gewinde G thread G	Innenform inside shape	Spannbereich (mm) clamping range (mm)	Steigung (mm) increments (mm)
T 223	28	34	82	16	M 25 x 1	○	3,0 - 21,0	0,5
							22,0	
						⬡	3,0 - 17,0	1,0
						□	3,0 - 14,0	1,0
T 223	28	34	82	16	M 27 x 1	○	22,0	
I 357	28	38	81	30	M 25 x 1	○	3,0 - 21,0	0,5
						⬡	4,0 - 17,0	1,0
						□	3,0 - 14,0	1,0
F 355	32	39	71	30	M 32 x 1	○	3,0 - 22,0	0,5
T 227	34	41	87,5	10	M 34 x 1	○	3,0 - 25,0	0,5
						⬡	4,0 - 22,0	1,0
						□	3,0 - 15,0	1,0
F 854	40	48	71	30	M 36 x 1	○	3,0 - 26,0	1,0
F 105	40	48	71	30	M 40 x 1	○	3,0 - 26,0	1,0
T 229	42	49	82	16	M 40 x 1	○	4,0 - 32,0	1,0
							33,0	
						⬡	4,0 - 27,0	1,0
						□	3,0 - 25,0	1,0
ML 36	44	51	82	16	M 42 x 1	○	3,0 - 35,0	1,0
ST 38	48	54	82	16	M 46 x 1	○	3,0 - 38,0	1,0

VERSTELLBARE FÜHRUNGSBUCHSEN MIT HARTMETALLEINSATZ, PROGRAMMIERBAR, FÜR TRAUB ADJUSTABLE GUIDE BUSHINGS WITH CARBIDE INSERT, PROGRAMMABLE, FOR TRAUB

Artikel part no.	Traub Zg.-Nr. Traub drawing number	$\varnothing d$ (mm)	$\varnothing D$ (mm)	Gewinde G thread G	Länge L (mm) length L (mm)	Konus α (Grad) cone α (degree)	Spannbereich (mm) clamping range (mm)	Steigung (mm) increments (mm)
FTS 221	989 468	21	24	M 18 x 1	65,5	12	1,5 - 16,0	0,1
FTS 3402	989 517	27	30	M 24 x 1	67,5	12	3,0 - 16,0	0,1
T 223 AXFIX	902 860	28	34	M 25 x 1	82	16	3,0 - 21,0	0,1
T 227	986 761	34	41	M 34 x 1	87,5	10	3,0 - 15,0	0,1